

# HP160-13

**Payload 160Kgf**

Installation method		Application	
Floor	●	Spot welding	
Ceiling		Arc welding	
Wall surface		Handling	●
		Assembly	
		Sealing	
		Painting	

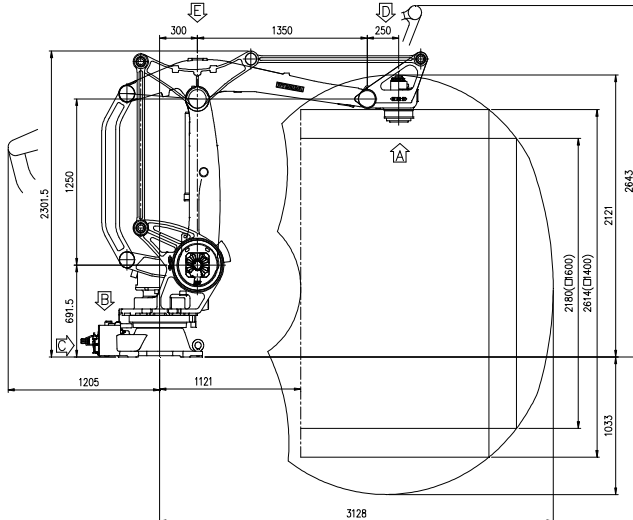
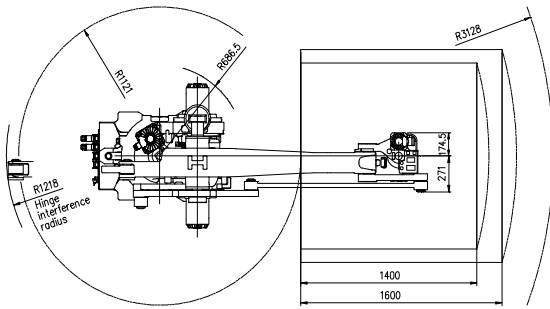

**View A: Detailed drawing of the wrist**

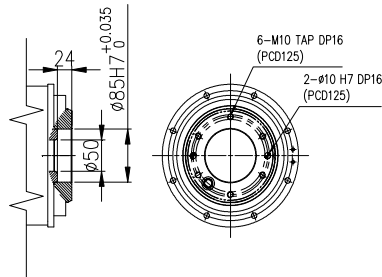

**View B: Dimensional drawing for the floor installation of the body**

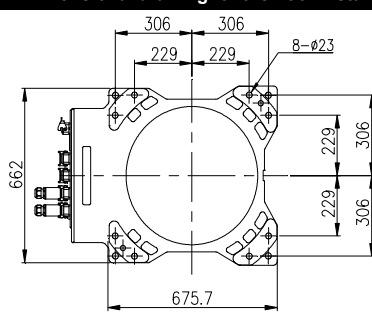

**Wrist-axis torque line diagram**

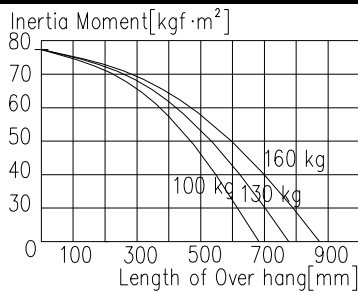

Item	Specification	Remarks	
Robot model	HP160		
Payload	160 kg	Including the hand weight	
Structure	Articulated		
Degree of freedom	4 axes		
Capacity	Box	1300 CPH	
	Bag	1558 CPH	
* Note: This capacity varies on loading condition/system configuration method.			
Max. working envelope	Swivel (S)	±180°	
	Loading zone (mm²)	□1400	2614 mm
		□1600	2180 mm
Wrist (W)		±360°	
Wrist permissible inertia	78 kg·m²		
Accuracy of position repeatability	±0.5 mm		
Ambient Temperature	0 ~ 45°C (273 ~ 318 K)		
Robot's Weight	1250 Kg		
Working envelope section area	5.76 m²		

[Note] The palletizing capacity is based on the result of the tests carried out at 100% load ratio, each with the standard pattern of our company (vertical: 400 mm; horizontal: 2,000 mm).

**View C: Application cable connection part**

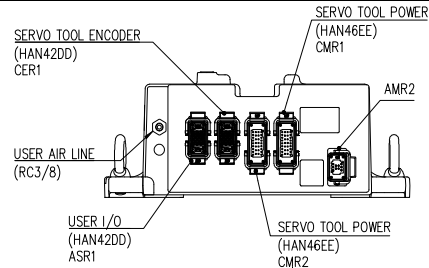

**View D: Application cable connection part**

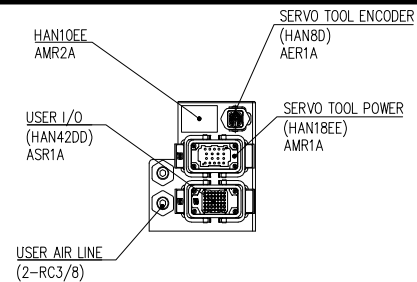

**View E: Details of the application ancillary part attachment**

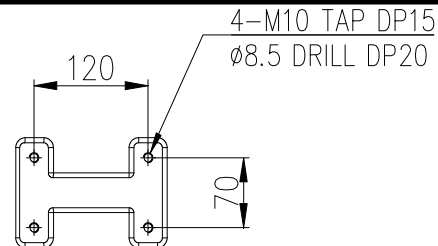

\*\* For product improvement, some of the ratings, specifications, dimensions, etc. are subject to changes without notice.