

# HH300

## Payload 300Kgf

Installation method		Application	
Floor	●	Spot welding	●
Ceiling		Arc welding	
Wall surface		Handling	●
		Assembly	
		Sealing	
		Painting	

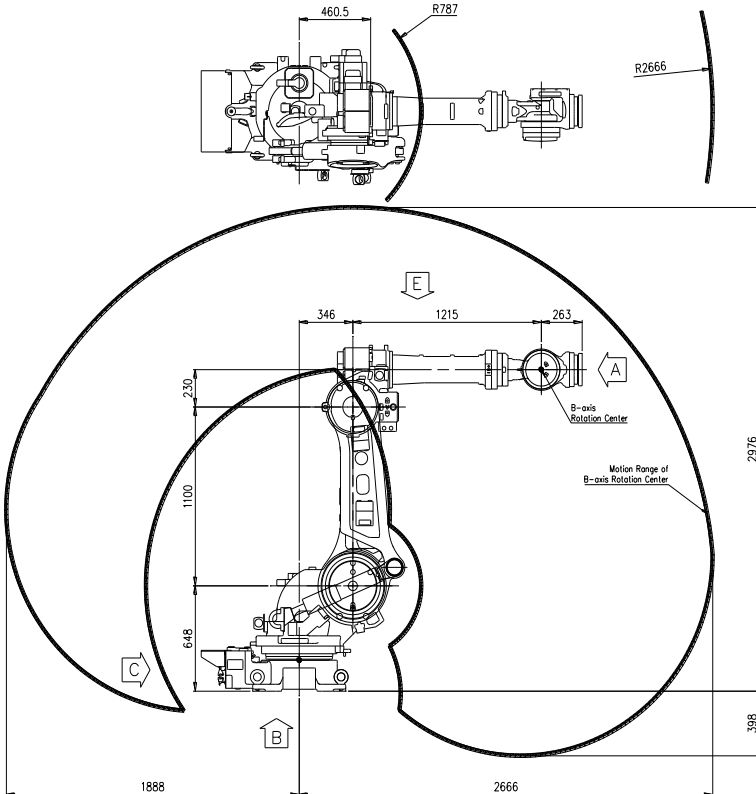

**View A: Detailed drawing of the wrist attachment part**

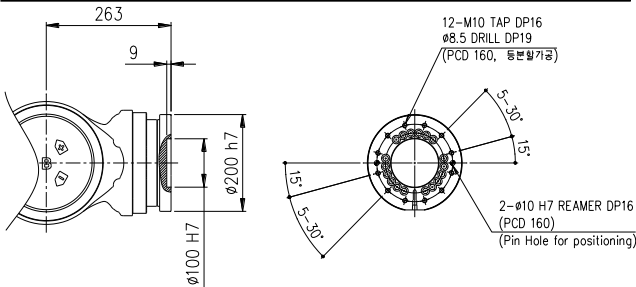

**View B: Dimensional drawing for the floor installation of the body**

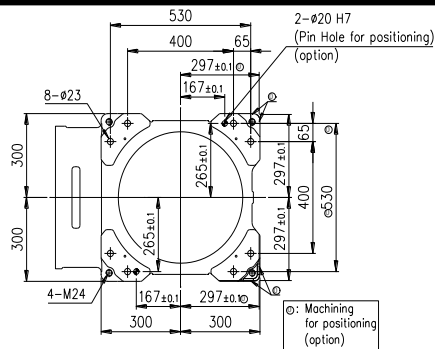

**Wrist-axis torque line diagram**

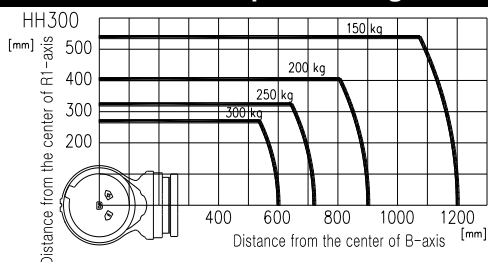

Item		Specification	
Robot model		HH300	
Payload		300 Kg	
Structure		Articulated	
Degree of freedom		6 axes	
Drive system		AC SERVO MOTOR	
Max. working envelope	A r m*	S Swivel	±3.141 rad (±180°)
		H Horizontal	+2.705 ~ 0.1745 rad (+155° ~ +10°)
		V Vertical	+3.316 ~ -1.396 rad (+190° ~ -80°)
	Wrist	R2 Rotation 2	±6.283 rad (±360°)
		B Bending	±2.182 rad (±125°)
R1 Rotation 1		±6.283 rad (±360°)	
Max. working speed	A r m	S Swivel	1.658 rad / s (95° / s)
		H Horizontal	1.484 rad / s (85° / s)
		V Vertical	1.484 rad / s (85° / s)
	Wrist	R2 Rotation 2	2.007 rad / s (115° / s)
		B Bending	1.920 rad / s (110° / s)
R1 Rotation 1		3.316 rad / s (190° / s)	
Wrist torque	R2 Rotation 2	1,769 Nm (180 kgfm)	
	B Bending	1,769 Nm (180 kgfm)	
	R1 Rotation 1	793 Nm (81 kgfm)	
Accuracy of position repeatability		±0.05 mm	
Ambient Temperature		0 ~ 45 °C (273 ~ 318 K)	
Robot's Weight		1,250 Kg	
Working envelope section area		8.92 m <sup>2</sup>	

**\*) When the optional limit switch is attached, the action range of the main axis will be limited (see the manual)**

**View C: Application cable connection part**

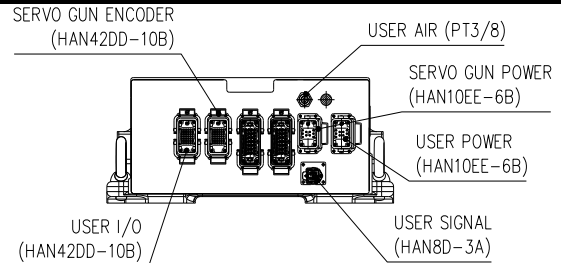

**View D: Application cable connection part**

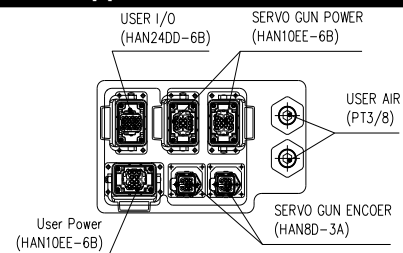

**View E: Details of the application ancillary part attachment**

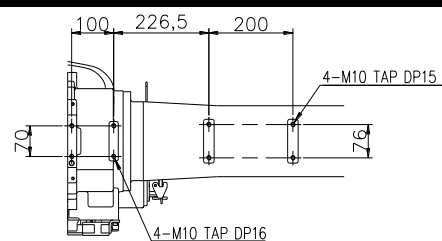

**\*\* For product improvement, some of the ratings, specifications, dimensions, etc. are subject to changes without notice.**